



# SALAD SPINNER SERIES

## ELECTRIC SALAD SPINNER EM 98 WITH TIMEOUT

Ref : E003.T



### DESCRIPTION

- Certified to NSF / ANSI 2-2009 : **North American Health standard certifying that the product meets strict requirements of quality and safety.**
- Ideal for spinning salads effortlessly for a better yield.
- Fast and efficient, it respects the product's fragility.
- Heavy duty construction for an intensive daily use.
- Outside container, top and inner basket in Polypropylene (Food-safe plastic).
- Antibacterial incorporated (biocide treated), complies with the HACCP requirements.



#### ACCESSORY

Ref. AC019



Stabilising base : base with the suction pads. For increased stability.



**WITH TIMEOUT**  
(RUNNING TIME 1 MINUTE)

#### USE

Indispensable to prepare high volume of salads.

#### Capacity : 20 L

Recommended for 3 - 5 lettuce heads.

#### MAINTENANCE

Before cleaning, unplug the wringer EM 98.

Wash the tray and basket with a water jet.

Clean the cover with a damp sponge.

**Do not immerse the lid in water.**

**Do not put in a dishwasher.**



#### TECHNICAL DATA

SPEED	500 tr/mn
TOTAL HEIGHT	630 mm
DIAMETER	430 mm
OUTPUT MAX	110-120V - 220-240V 50-60Hz
VOLTAGE	200 W
ACTUAL WEIGHT	8,3 kg

[www.dynamicmixers.com](http://www.dynamicmixers.com)

Dynamic - 518 rue Léo Baekeland BP57 - 85290 Mortagne sur Sèvre

Tel : +33 (0)2 51 63 02 72 • E-mail : [export@dynamicmixers.com](mailto:export@dynamicmixers.com)

Follow us on social networks!



# TECHNICAL SHEET

## Ref E003 / E003.T

Parts list Code

SELF LUBRICATING RING	0603
HANDLE SCREW	0720
HANDLE	0782
FRICTION WASHER	0787
MOTOR HOUSING SCREWS	079917
MOTOR SCREW	079929
HEXAGON SOCKET SET SCREW M6X30	079980
HAEXAGONAL SERRATED FLANGE NUT M6	079981
SMALL GEAR MOTOR SHAFT	0831
PUSH SWITCH	0905
SWITCH PROTECTOR	0905.1
STRAIN RELIEF 220-240 V	0950
STRAIN RELIEF 110-120 V	0950.1
POWER CORD (220-240V)	0966
POWER CORD 110-120 V	0967
POWER CORD (ENGLAND)	0973
POWER CORD (AUSTRALIA)	0974
OUTSIDE BASKET + AXLE	2801
COVER WITHOUT SMALL COVER, HANDLE & GEAR	2804
OUTSIDE BASKET AXLE	2810
AXLE	2814
MOTOR HOUSING FOR SALAD DRYER WITHOUT TEMPO (WITH LABEL)	3001

## Ref E003 / E003.T

Parts list Code

MOTOR HOUSING FOR SALAD DRYER WITH TEMPO	3001.1
BIG GEAR	3002
GEAR HOUSING PROTECTOR	3003
MOTOR 220-240V ( + CAPACITOR)	3004
MOTOR 110-120 V ( + CAPACITOR)	3004.1
MOTOR PLATE	3005
SMALL GEAR	3006
AXLE, BIG GEAR	3007
CAPACITOR 220-240 V	3008
CAPACITOR 110-120 V	3008.1
COMMAND CIRCUIT WITH TEMPORIZATION	3009
SALAD SPINNER COMPLETE COVER 220-240V	3010
SALAD SPINNER COMPLETE COVER 110-120V	3010.1
COMPLETE COVER FOR SALAD SPINNER WITH TEMPORIZAZION 220-240V	3010.T
COMPLETE COVER FOR SALAD SPINNER WITH TEMPORIZAZION 110-120V	3010.T.1
220-240V MOTOR WITH SHAFT	3024
110-120V MOTOR WITH SHAFT (FROM SERIAL NUMBER 19/00179)	3024.1
BUCKET 20L	P2802

E003.T

P2802

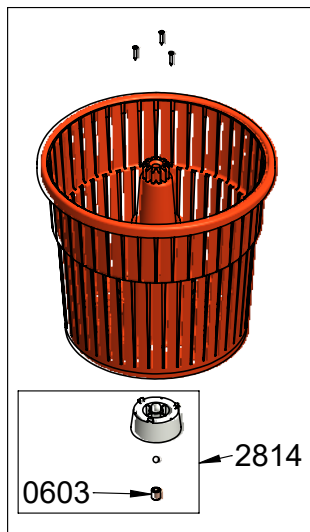

2801

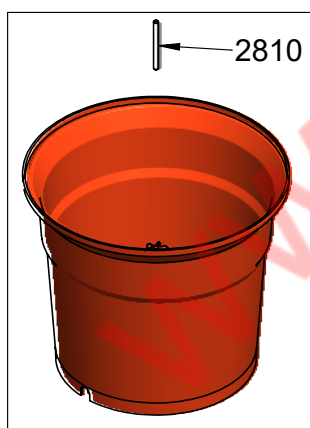

3010.T-3010.T.1

